

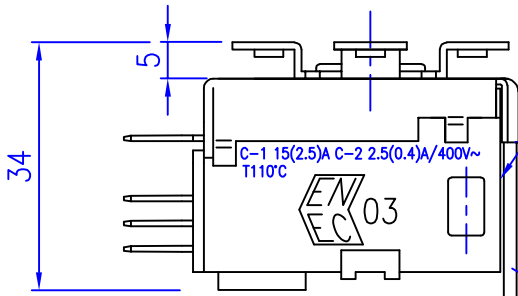

Printing on left side



Label with production date and lot number



Covered with PVC black (940)

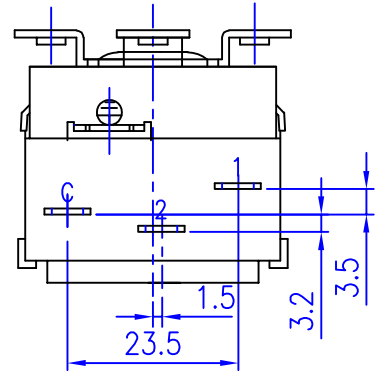

Stainless Steel Capillary and Bulb

1000±50

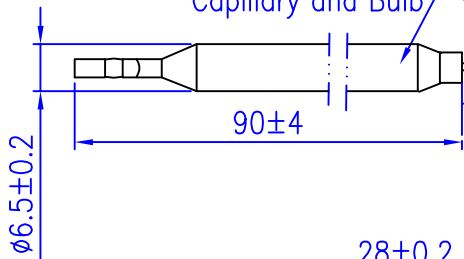

Electric diagram: S.P.D.T

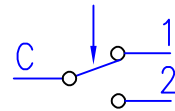

Terminal C-1 opens at temperature rise
Terminal C-2 closes at temperature rise

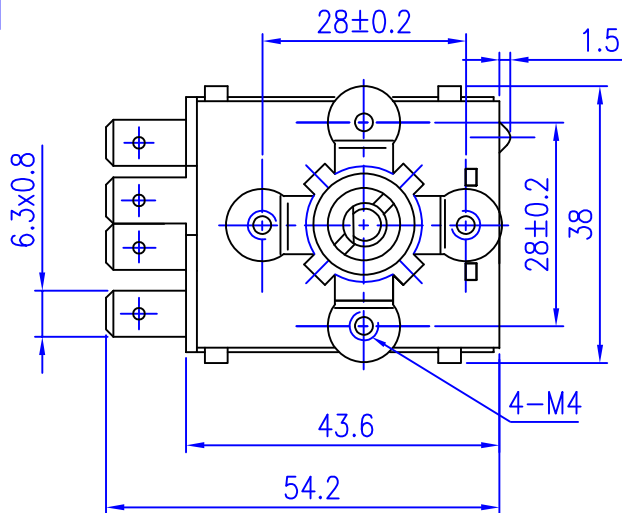

Technical Parameter

- H/off: $80 \pm 3^\circ\text{C}$ Diff: $4 \pm 2^\circ\text{C}$
- Breaking capacity
C-1 15 (2.5)A 400V~
C-2 2.5(0.4)A 400V~
- Insulation Resistance: $>100\text{M}\Omega$
- Dielectric Strength: AC 2000V 1min
- Temperature change speed: $<1.0^\circ\text{C}/\text{min}$
- Maximum temperature:
Around the Sensing Body $T_{110}^\circ\text{C}$
Around the Sensing Bulb 120°C
- Rotating Torque of Adjustment Shaft: $<0.4\text{Nm}$
- Life of Product: 100,000 Cycles

REMARK:

The operating temperature above is at 25°C ambient temperature (temperature around the switch body), If the ambient temperature changes, the operating temperature needs modified.

Correction factor: $C = -0.16(\text{K}/\text{K})$

The product has been given the following safety approval: ENEC

Submerged capillary length: $50 \pm 30\text{mm}$.

SIGN	A1	DRN	A. Falzone	T&P Srl Galliate (No) ITALY	Code: TP-312C.80
		CHD			Drawing: ZA80C-503-12C
DATE	Jan.07.2020	ENG		WIRING DIAGRAM Liquid Expansion Thermostat	Customer code:
		APPR			